

QUICK GUIDE - Superdew 3 WP DEWPOINT HYGROMETER INSTALLATION



MOISTURE METERS

There are several different ways to mount the Superdew 3 WP to the wall: hook, DIN Rail and wall mount bracket.

HOOK

On the rear of the enclosure there is a hole to accept a hook or screw head for hanging. The thickness of the enclosure here is 3.7 mm therefore, the minimum gap for the slot is recommended to be 4 mm.



Ensure that the extremity of the hook or screw head protrudes no further than 12 mm from the wall.

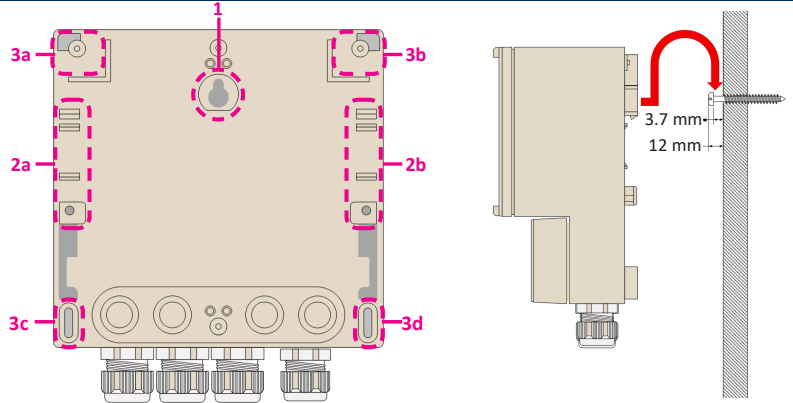

DIN RAIL



A DIN Rail mounting kit is supplied with the instrument.

DIN Rail of type EN60715 35 mm x 15 mm is compatible.



The plastic pieces attach to the rear of the enclosure.

The DIN rail can then be mounted and the clips rotated to secure.

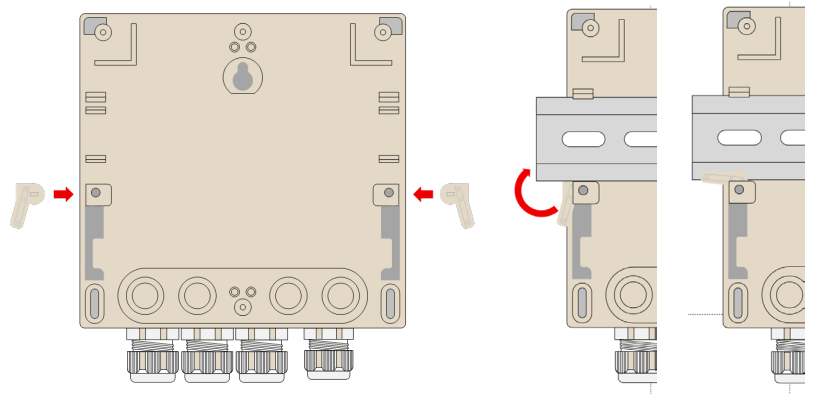

WALL MOUNT BRACKET

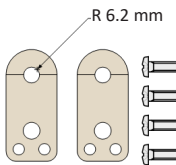

A wall mount bracket kit is supplied with the Superdew 3 WP. The two brackets mount to the rear

of the enclosure. The enclosure can then be fixed to the wall from the front using M5 screws or similar.

Fit the two brackets to the top of the enclosure at each corner.

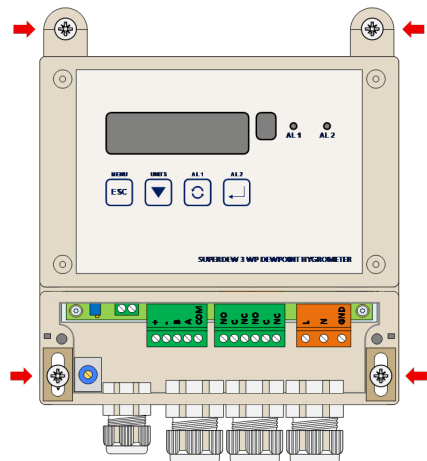

The terminal cover must be removed to mount the product to the wall.

Use M5 screws or similar to mount the product at the four mounting points shown.

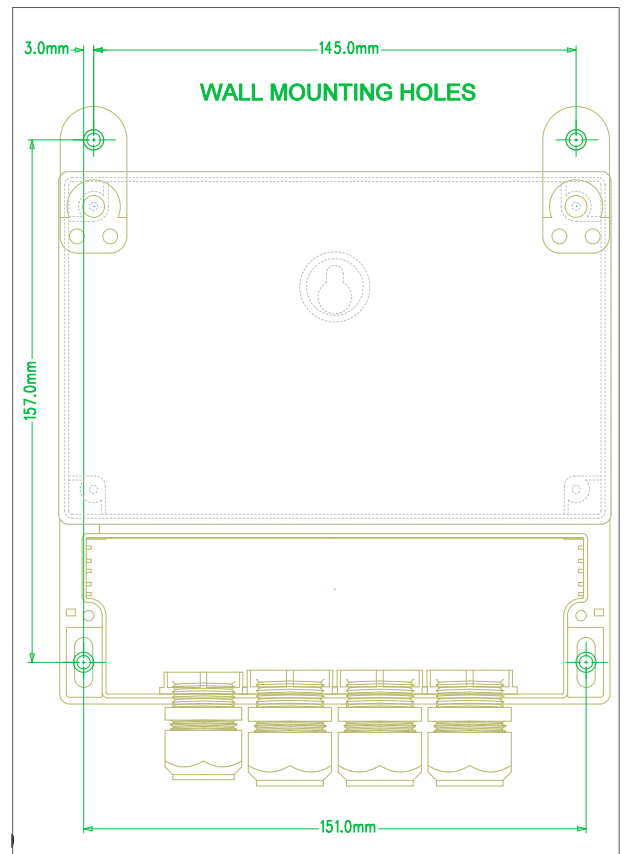

For technical help please contact: Shaw Moisture Meters +44 (0) 1274 733582

QUICK GUIDE - WIRING THE Superdew 3 WP DEWPOINT HYGROMETER

INSTRUMENT WIRING

BEFORE YOU BEGIN



Ensure that the power is disconnected prior to removing the terminal cover.

- ① Remove the terminal cover by loosening the two screws. The cover should lift off while still retaining the screws.
- ② For working on the power connection, there is an additional High Voltage Guard which can be removed using the single screw in the corner. This screw will be retained with the guard.

The Main PCB connectors will now be visible.

- ③ Insert cable of appropriate diameter through the cable gland.

The cable gland on the left feeding the sensor connections is M16 type and the recommended cable outer diameter is 5-9.5 mm. The other three cable glands are M20 type and the recommended cable outer diameter is 8-13 mm.

When fitting the sensor cable, exert downward pressure while inserting, to thread the tags through the gland as shown in fig. 1.2.



Ensure that the supplied blanking plugs are securely fitted to any unused cable glands. This will maintain the IP rating of the enclosure.

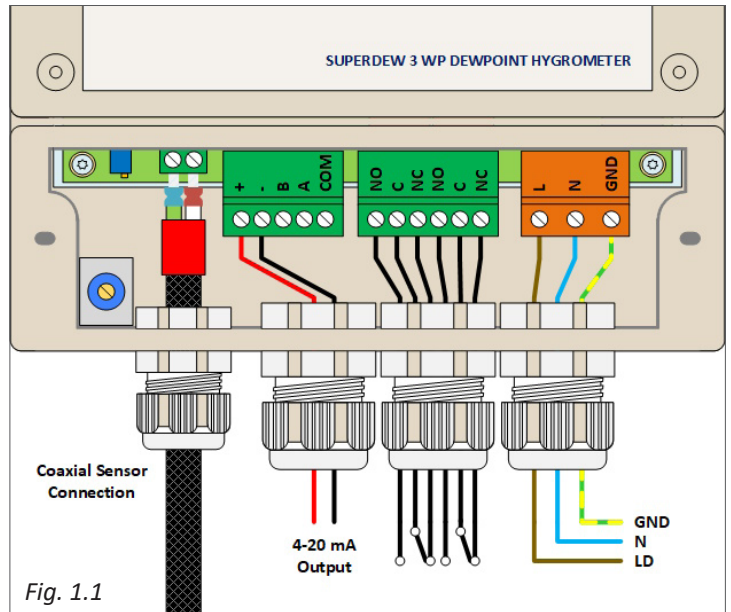

Fig. 1.1

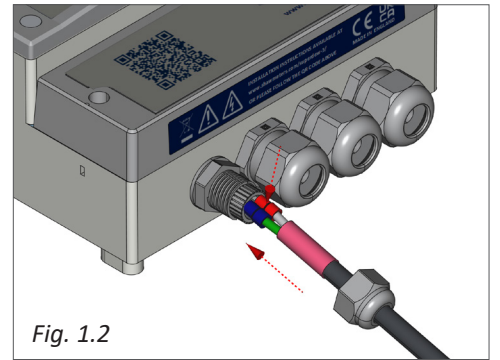

Fig. 1.2

POWER SUPPLY

The Superdew 3 WP can be powered by either a 90-250 V AC or 24 V DC supply. Connect the required supply cable to the appropriate terminals as shown in fig. 1.1.

The AC power supply should be between 90-250 V AC @ 50/60 Hz. The power supply wires are retained by screws. Ensure that the exposed section of wire is fully inserted and that no loose strands are exposed.



Ensure that all connector screw clamps are screwed down tightly to prevent movement of the cable. Once the connector clamps are screwed down tightly, ensure all cable glands are tightened to prevent movement of the cable.

ALARM and OUTPUT CABLE CONNECTORS

Connect the required cables to the appropriate terminals as shown in fig 1.1. **Note:** The normally open and normally closed relay contact positions and that the correct polarity and the maximum load specification are strictly observed for the analogue outputs.

Ensure that the wire is fully inserted and that no loose strands are exposed.



Ensure that all connector screw clamps are screwed down tightly to prevent movement of the cable. Once the connector clamps are screwed down tightly, ensure all cable glands are tightened to prevent movement of the cable.

SENSOR CABLE

Connect the sensor coaxial cable into the coaxial socket shown in fig 1.1. Route the sensor cable to the intended site of the sensor.



Ensure that all connector screw clamps are screwed down tightly to prevent movement of the cable. Once the connector clamps are screwed down tightly, ensure all cable glands are tightened to prevent movement of the cable.

For technical help please contact: Shaw Moisture Meters +44 (0) 1274 733582